

SERIES: TECHLINE

MODEL NUMBER: TR233

DESCRIPTION: THREE PANEL OVER THREE PANEL, 2 LAMP, RECESS MOUNT CONFIGURATION

FRONT VIEW

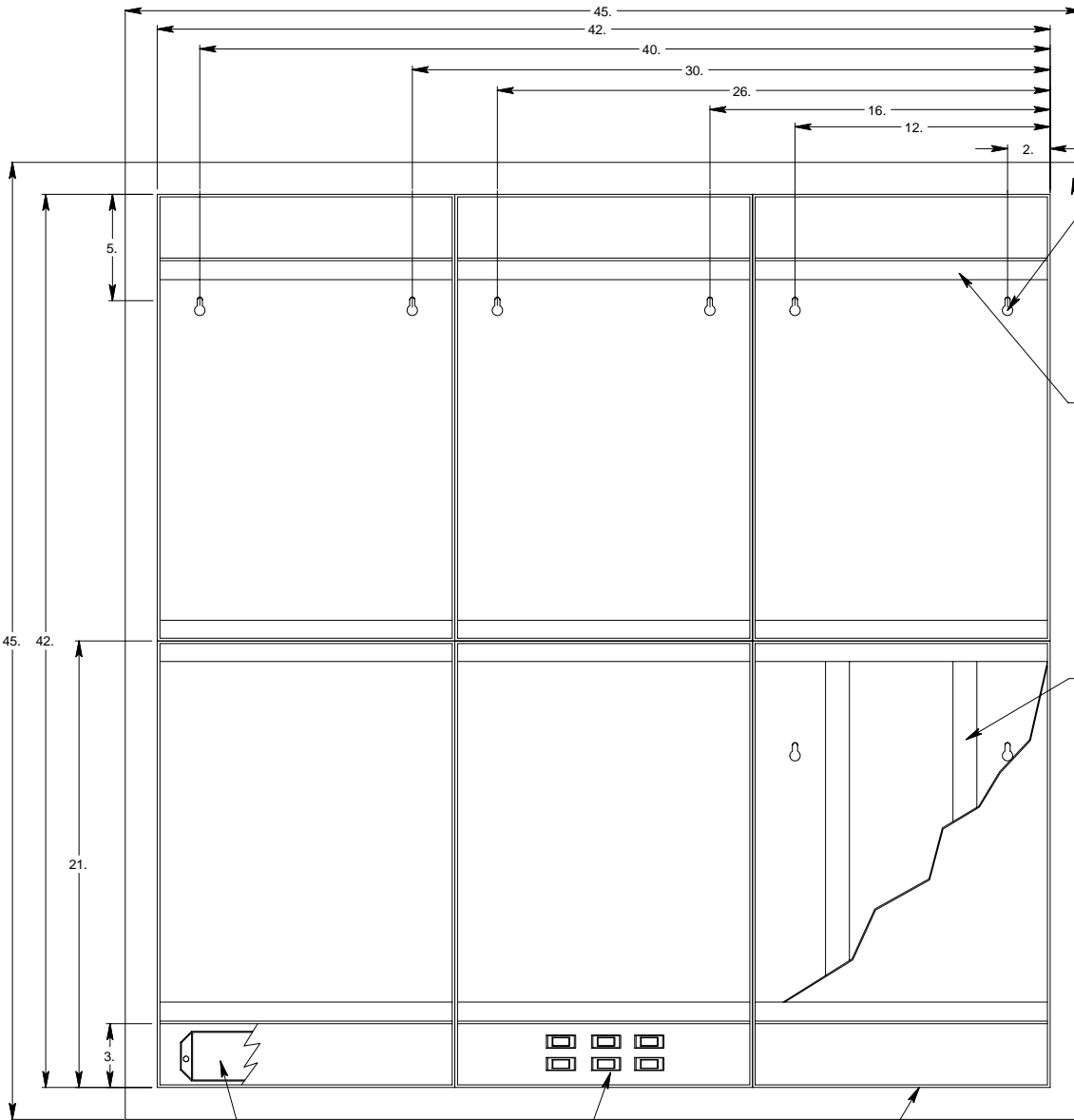

(1) BALLAST PER PANEL:
RAPID START, LOW LEAKAGE
THERMALLY PROTECTED
CLASS P TYPE
200 SERIES-0.72 AMPS/PANEL
PN - 1039U

SWITCHING MODULES
STANDARD ON/OFF

BODY IS STANDARD
18 GAUGE WELDED
STEEL CONSTRUCTION

ROUGH IN CUT OUT DIMENSION: 42 3/4" X 42 3/4"

RIGHT VIEW

1 1/2" RECESS TRIM FLANGE
IS FACTORY ATTACHED ON EACH
OF THE FOUR SIDES OF RECESS
MOUNTED CONFIGURATIONS

3/8" MAX DIA. FOR FASTENING FIXTURE
TO WALL, KEYHOLE 3/16" SLOT

ROLLER GRAVITY
FILM RETAINER

FLUORESCENT LAMPS PROVIDED.
LAMP MODEL# F15T8/D
2 EA-(200 SERIES)

STANDARD REMOVABLE
ACCESS WIREWAY PANEL

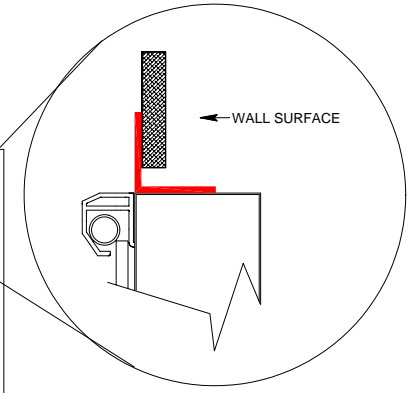

NOTE:
DO NOT DISTORT THE FIXTURE.
USE SHIMS BETWEEN THE FIXTURE
AND THE WALL CUT-OUT FRAMING AT
SCREW FASTENING LOCATIONS.

1" KNOCK-OUT TYPICAL
RIGHT HAND SIDE IS STANDARD
LOCATION ON RECESS
MOUNTED FIXTURES.

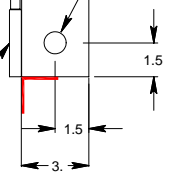

MAXANT TECHNOLOGIES, INC.
7540 CALDWELL AVE.
NILES, IL. 60714
(800) 307-4190